

EKF 411 N AL UD

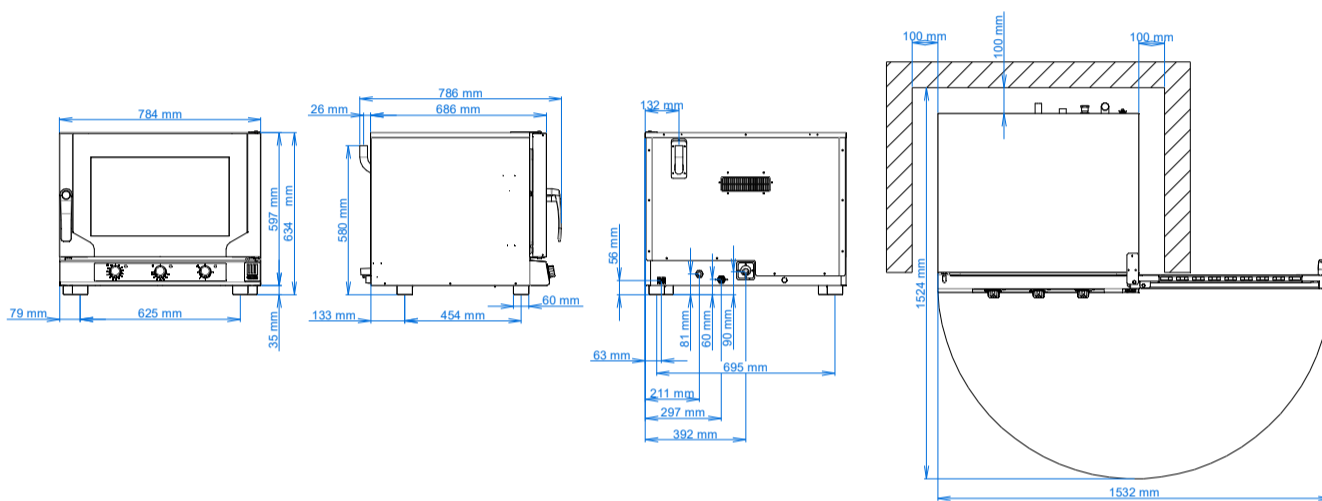

ELECTRIC CONVECTION OVEN WITH DIRECT STEAM

Use: Gastronomy



DIMENSIONAL FEATURES			
Oven dimensions (WxDxH mm)	784	786	634
Oven weight (kg)	56,4		
Distance between rack rails (mm)	73		

FUNCTIONAL FEATURES	
Power	Electricity
Capacity	N° 4 trays/grids 1/1 GN
Type of cooking	Ventilated
Steam	Direct steam controlled by knob (5 levels)
Cooking chamber	AISI 304 Stainless steel
Temperature	100 - 260 °C
Temperature control	Thermostat
Control panel	Electromechanic - Lower side
N° of programs	/
Programmable cooking steps	/
Pre-heating temperature	/
Pre-heating function	/
Door	Right side opening door Ventilated Inspectionable glass
Modularity	Available

ELECTRICAL FEATURES	
Power supply (kW)	6,4
Frequency (Hz)	50 (60 on demand)
Voltage (Volt)	AC 380/400 3N
N° of motors	2 Bidirectionals
Boiler	/
Protection against water	IPX4

EQUIPMENT			
Cardboard box dimensions (WxDxH mm)	805	830	800
Lateral supports	1 right + 1 left		
Cable	Two-phases+Neutral [5G 2,5] - L=1600 mm		
Manual washing set up			